

GREATER LONDON CITY OF WESTMINSTER PLAN

IN PARLIAMENT - SESSION 2004-05

CROSSRAIL

Works Nos. 1/2, 1/3A, 1/3B & 1/8B (Railways)
Works Nos. 1/10A & 1/10B (Sewers)
For Section of Work No. 1/2 see Sheet Nos 144 & 145
For Sections of Works Nos. 1/3A & 1/3B see Sheet Nos. 146 - 159
For Section of Work No. 1/8B see Sheet No. 176
For Sections of Works Nos. 1/10A & 1/10B see Sheet No. 177

Westbourne Bridge Shaft

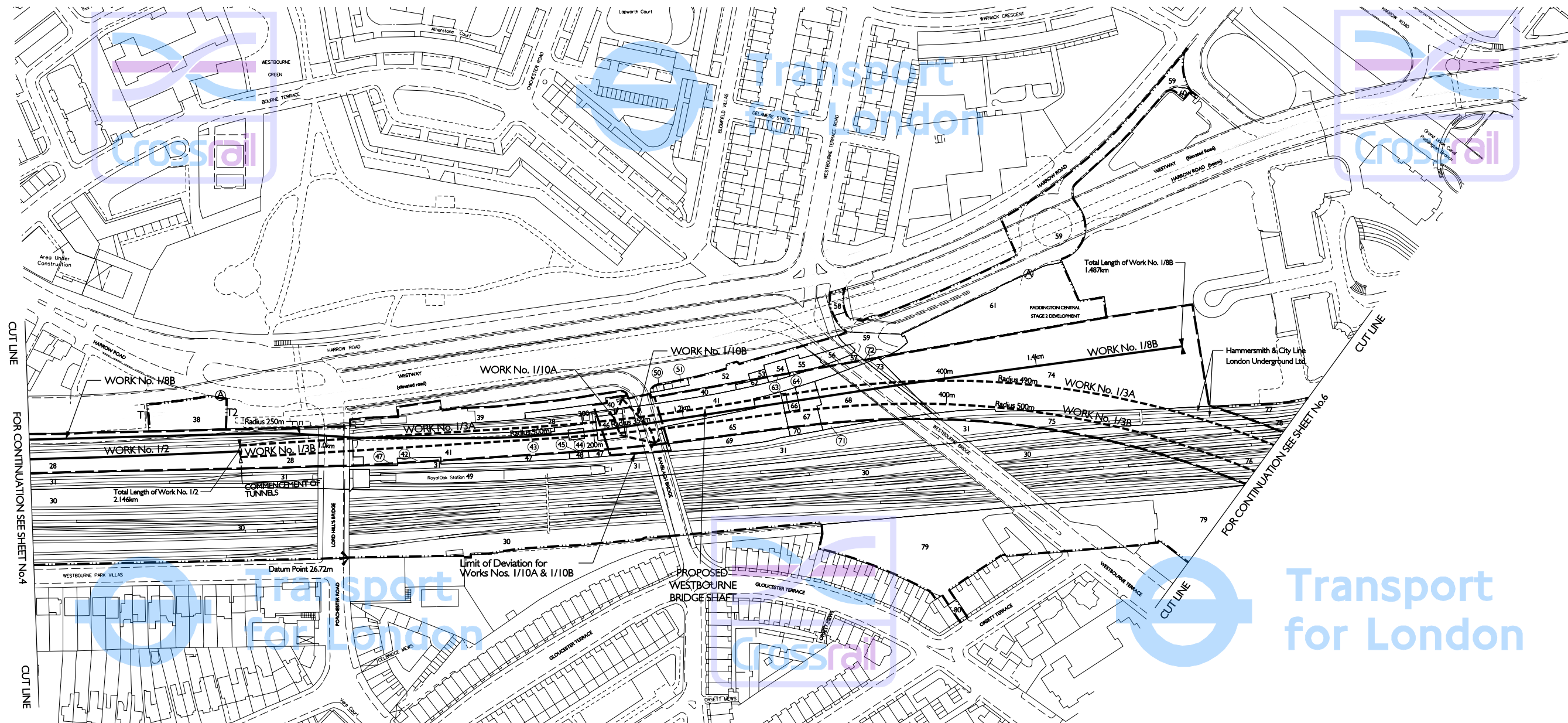

THIS MAP IS BASED UPON ORDNANCE SURVEY MATERIAL WITH THE PERMISSION OF ORDNANCE SURVEY ON BEHALF OF THE CONTROLLER OF HER MAJESTY'S STATIONERY OFFICE © CROWN COPYRIGHT. UNAUTHORISED REPRODUCTION INFRINGES CROWN COPYRIGHT AND MAY LEAD TO PROSECUTION OR CIVIL PROCEEDINGS. (GLA - 100032379) (2005).

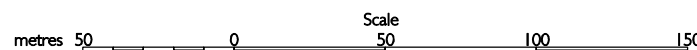

The area enclosed by any limit of deviation or by any limit of land to be acquired or used is the area extending to the outer edge of the line marking those limits.

For key to symbols and line styles see Index Sheet

Scale is 1:1,250 at A1 size

Drawing No. I10401-C1 G00-F00-F-50002 Rev J